

ITEM NO.	PART NUMBER	DESCRIPTION	MATERIAL	DRAWING	QTY.
1	FP-HF12-HANDLE	LEFT HINGE PIVOT HANDLE	3/8" HRS.	30-2225	1
2	FP-HF12-LID LATCH	LATCH, HYDRA FEEDER LID	1/4" HRS.	30-2308 B	1
3	ST-HR .75 ROUND L 4.5	LENGTH: 4-1/2"	HR ROUND 3/4"	-	1

REVISIONS			
REV.	DESCRIPTION	DATE	APPROVED
A	INITIAL RELEASE	4/14/2017	
B	REVISE LENGTH	5/5/2017	

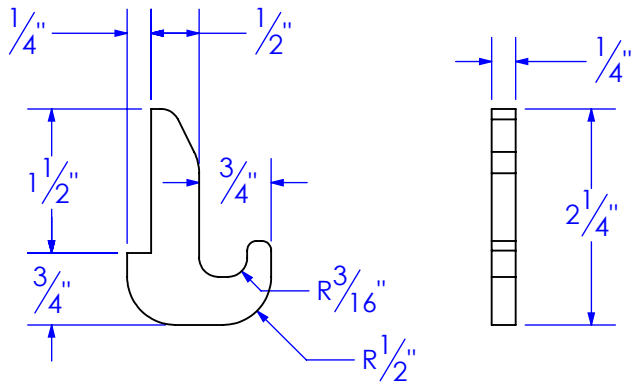

FP-HF12-LID LATCH  
LATCH, HYDRA FEEDER LID  
MATERIAL: 1/4" HRS

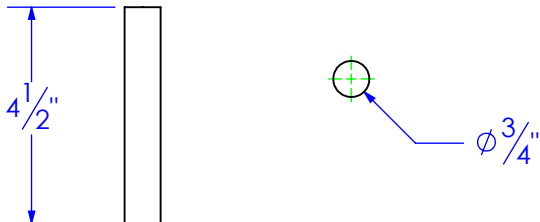

ST-HR .75 ROUND  
LENGTH: 4-1/2"  
MATERIAL: HR ROUND 3/4"

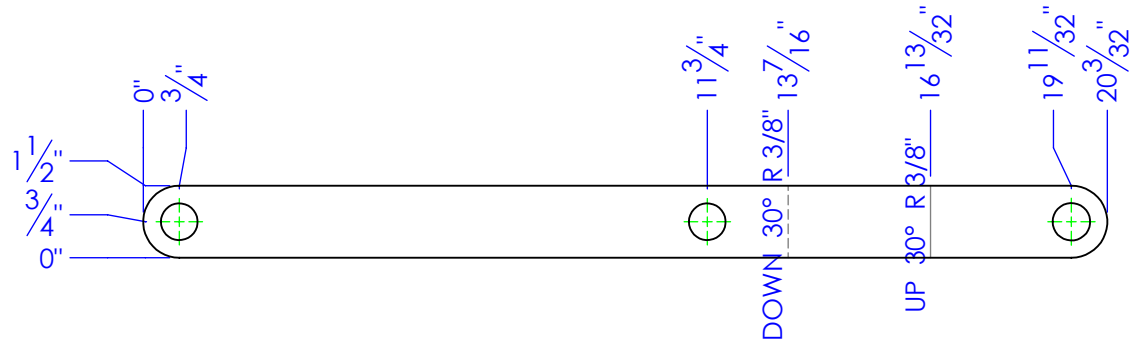

FP-HF12-HANDLE  
LEFT HINGE PIVOT HANDLE  
MATERIAL: 3/8" HRS

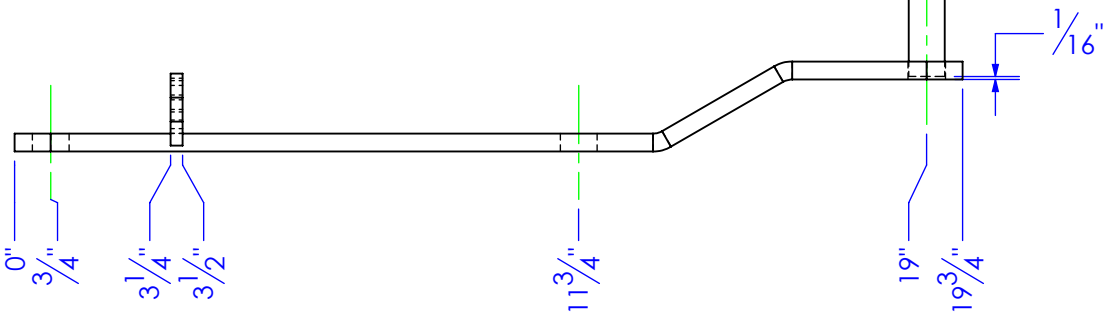
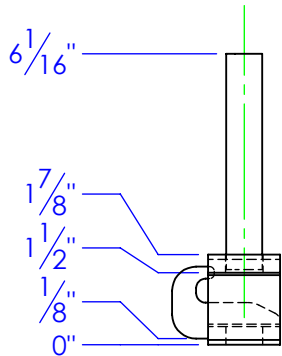
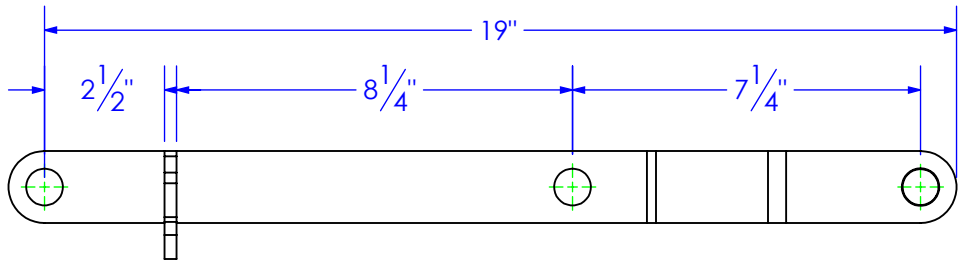
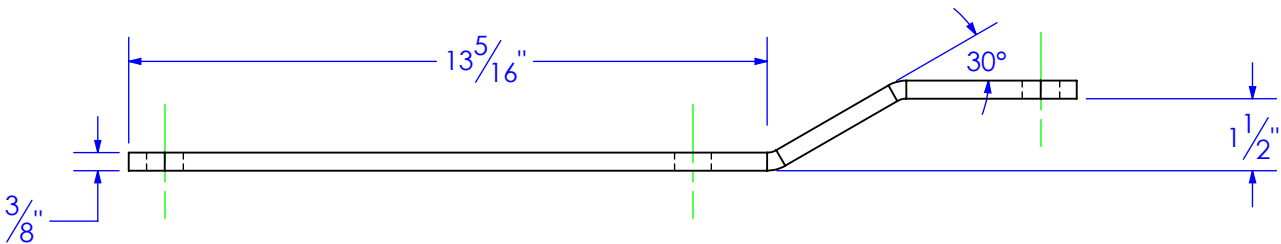
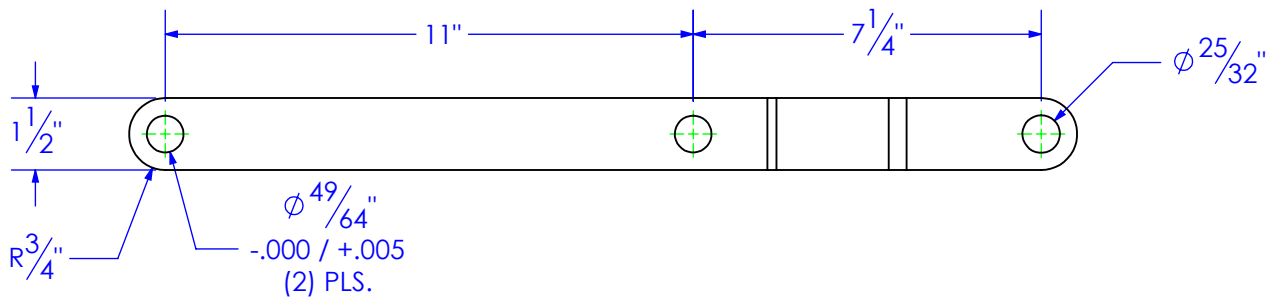

POWDERCOAT GLOSS BLACK

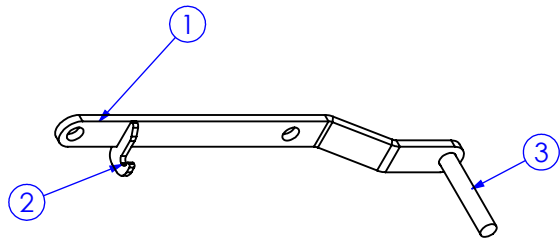

PROPRIETARY AND CONFIDENTIAL  
THE INFORMATION CONTAINED IN THIS  
DRAWING IS THE SOLE PROPERTY OF TRIPLE  
C INC. ANY REPRODUCTION IN PART OR  
AS A WHOLE WITHOUT THE WRITTEN  
PERMISSION OF TRIPLE C, INC IS PROHIBITED.

UNLESS OTHERWISE SPECIFIED:  
DIMENSIONS ARE IN INCHES  
TOLERANCES:  
FRACTIONAL  $\pm 1/16$   
ANGULAR: MACH  $\pm 1$  BEND  $\pm$   
TWO PLACE DECIMAL  $\pm .010$   
THREE PLACE DECIMAL  $\pm .005$   
MATERIAL  
DO NOT SCALE DRAWING

	NAME	DATE
DRAWN	ETHAN	5/5/2017
PART #	Part #	
ASM #	HF-HF12-53	
COMMENTS:		
HANDLE, HF-1200		

P.O. BOX 248, SABETHA, KS 66534 (785) 284-3674 FAX (785) 284-3931			
<b>TRIPLE C</b> INC			
SIZE	DWG. NO.	REV	
B	30-1253	B	
SCALE: 1:8	WEIGHT:	SHEET 1 OF 1	